

No	Part #	Description	Application	Qty Req	Price Each
1	ALH1893	Instrument panel (U)		1	104.50
2	ALH865	Defroster nozzle (U)		2	6.60
3	ALH1885	Door		1	148.50
4	ALH1896	Lock w/key		1	104.50
5	ALH1897	Bumper, rubber		2	3.25
6	ALH2497	Glovebox		1	32.73
7	14A9443	Ashtray		1	20.08
8	14A9438	Brace, RH (U)		1	6.60
9	14A9437	Brace, LH (U)		1	6.60
10	11G9145	Speedometer, MPH		1	97.90
	11G9147	Speedometer, KPH		1	75.90
11	17H668	Gasket		1	6.88
12	27H1296	Clamp		2	4.40
13	17H1304	Nut		2	3.14
14	3H2822	Fuel gauge, instrument panel		1	34.93
15	17H1782	Cable, speedometer	-E11000	1	65.84
	1H9047	Cable, speedometer	E11001-	1	28.33
16	RFN405	Grommet		1	4.79
17	3H2765	Signal indicator assy		1	21.95
18	2H4732	Bulb, screw base		7	1.71

No	Part #	Description	Application	Qty Req	Price Each
19	1G2596	Courtesy light assy		1	17.33
20	811 2128	Cigar lighter assy	-E34076	1	46.75
	11G9133	Cigar lighter assy	E34077-	1	46.75

A faulty or inoperative fuel gauge is almost never due to the dash unit. See tank units on page 10.

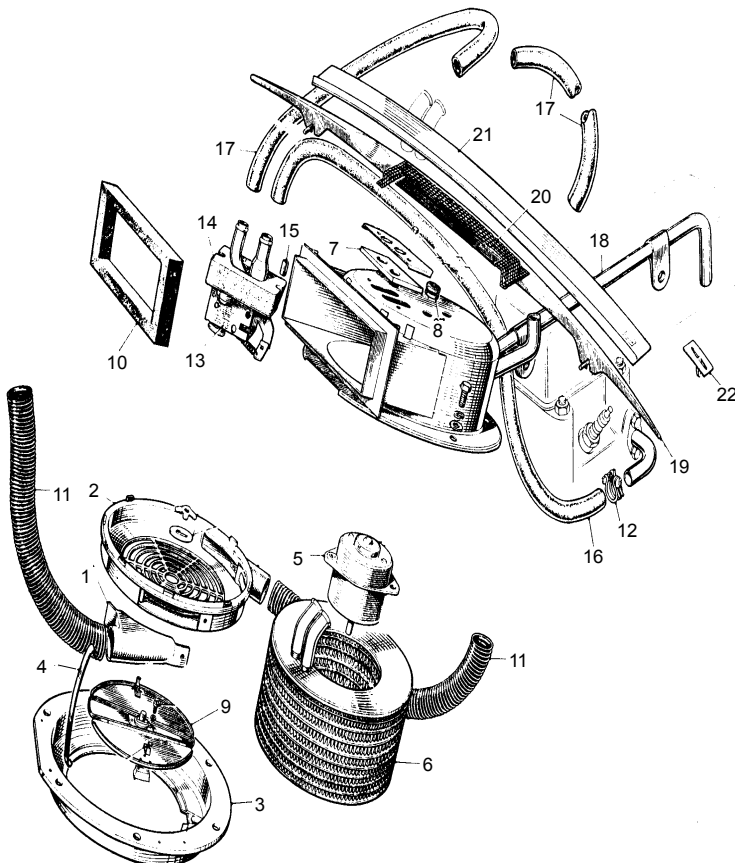

No	Part #	Description	Application	Qty Req	Price Each
	14A9400	Heater assy (X65)		1	203.50
	CP302	ID plate, heater		1	5.89
1	27H1226	Defroster nozzle (U)		2	9.90
2	27H1239	Front cover (U)		1	17.60
3	27H1225	Shroud, rubber		1	109.73
4	27H596	Clip (U)		3	7.43
5	17H1487	Motor (X20)		1	76.45
6	27H1240	Heater core		1	17.60
7	27H1229	Seal		1	4.35
8	27H1232	Grommet		3	3.03
9	27H1237	Door assy (U)		1	17.60
10	14A9418	Gasket		1	20.63
11	14A9405	Defroster duct		2	14.03
12	8G518	Clamp		7	2.92
13	2A9007	Control valve (X35)		1	109.73
14	3H2827	Seal		1	8.53
15	3H2828	Spacer		2	2.48
16	1G2921	Hose, elbow/valve		1	6.44
17	1G2268	Hose, valve/heater & heater/pipe		2	5.45
18	1G2918	Return pipe, copper (U)		1	0.00
19	ALH868	Cowl vent (U)		1	137.50
20	ALH1479	Screen		1	16.23
21	ALH1477	Weatherstrip, cowl		1	14.03
22	ALA4468	Clip		8	1.10